

INSTRUCTIONS FOR USE - Smith & Nephew

1. Place The Pink Hip Pad[™] at the distal section of the table so that **the pad makes direct contact with the table's surface**. Position the white Velcro straps on the underside of The Pink Hip Pad so that the "This Side Up" tag is facing upwards.
2. Attach both white Velcro straps to the surgical bed rails by looping under the rail and affixing the ends of the Velcro together as seen in Figure 1.
3. Attach purple strap under the surgical table attachment by first placing the longer end of the purple straps under the table, followed by overlapping the longer end of the strap with the shorter end of the strap.
4. Place head positioner above The Pink Hip Pad in a location sufficient for the patient head placement. (Figure 2)
5. Lay the lift sheet over the pad, centered above the alignment tabs straps as shown in Figure 2. The lift sheet should cover only the portion of the pad that will be addressing the small of the patient's back – below the Scapula Region and above the Sacrum. Begin IV or intubation according to hospital protocol.
6. Begin positioning the patient on The Pink Hip Pad with the lift sheet provided. Utilize the lift sheet to carefully lift the patient up off the pad to reposition as needed for safe and proper application. **Do not drag patient on pad and make sure the pad remains flat all times.**

FIGURE 1

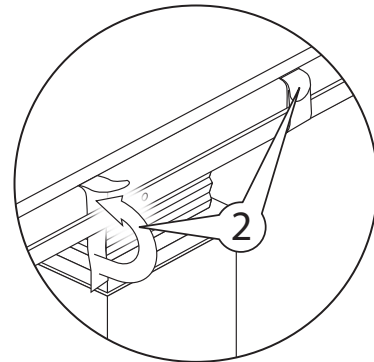
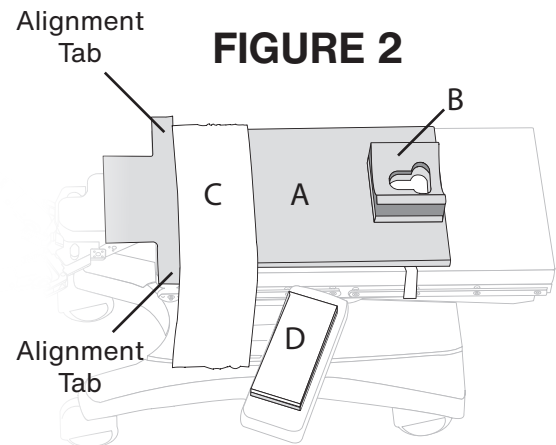

FIGURE 2



- A - Pink Hip Kit Pad
- B - Head Positioner
- C - Lift Sheet
- D - Arm Board
- E - Body Strap

7. Place patient's feet in bootliners then wrap patient's feet according to hospital protocol.
8. Place one Arm Board Pad under the patient's arm that is the opposite side of the operative hip. Place arm on arm board with palms up, or per hospital positioning protocol. (Figure 3)
9. Lay other arm across patient's chest with the other arm board pad so that it cushions the patient's arm on their chest. (Figure 3)
10. Place purple body strap across patient's arm and attach the body straps as follows:
 - 10A. Place the strap component with the small Velcro square around the table's accessory rail and through strap buckle
 - 10B. Repeat the above step on the other side of the table with the remaining strap component with the Velcro's hook side facing downward. Join the straps together so that it goes over the patient's arm and chest
11. Place the patient's wrapped feet into stirrups, then tighten down according to hospital policy, and then begin postless hip distraction process.

FIGURE 3

- A - Pink Hip Kit Pad
- B - Head Positioner
- C - Lift Sheet
- D - Arm Board
- E - Body Strap

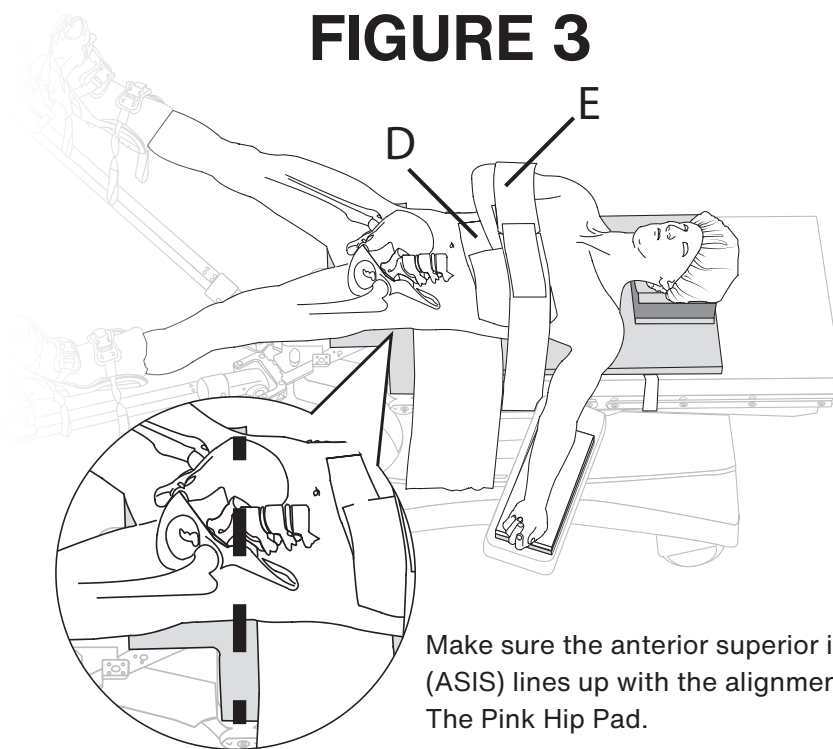

Make sure the anterior superior iliac spine (ASIS) lines up with the alignment tabs of The Pink Hip Pad.

IMPORTANT

- The anterior superior iliac spine (ASIS) is positioned directly on the alignment tabs so that at least six inches of pad remains distal to the patient's buttocks.
- If patient presents an anatomical challenge during attempted distraction, the use of Air Arthrogram could ease the distraction process.

ATTENTION:

- A. Before using The Pink Hip Kit, ensure O.R. table pad is securely affixed to the O.R. table.
- B. Be sure to follow your facility's policies and guidelines for frequency of patient monitoring. Check for skin integrity and proper circulation. Product is to be used by a licensed medical professional only.