

The Pink Hip Kit[®]

Postless Hip Positioning System

Instructions for Use

1. Place The Pink Hip™ Pad at the distal section of the table so that the pad makes direct contact with the table's surface. Position the white Velcro straps on the underside of The Pink Hip Pad so that the "This Side Up" tag is facing upwards.
2. Attach both white Velcro straps to the surgical bed rails by looping under the rail and affixing the ends of the Velcro together as seen in Figure 1.
3. Place the head positioner above The Pink Hip Pad in a location sufficient for the patient head placement.
4. Lay the lift sheet over the pad, centered between the white straps. The lift sheet should cover only the portion of the pad that will be addressing the small of the patient's back – below the Scapula Region and above the Sacrum. Begin IV or intubation according to hospital protocol.
5. Begin positioning the patient on The Pink Hip Pad with the lift sheet provided. Utilize the lift sheet to carefully lift the patient up off the pad to reposition as needed for safe and proper application. Do not drag patient on pad and make sure the pad remains flat all times.
6. Place patient's feet in boot liners (If appropriate) then wrap patient's feet according to hospital protocol.
7. Place the non-operative leg onto the attached leg stirrup with the knee at a 90 degree angle.
8. Place one Arm Board Pad under the patient's arm that is the opposite side of the operative hip. Place arm on arm board with palms up, or per hospital positioning protocol.
9. Place the other arm across patient's chest with the other arm board pad or on to the attached limb holder so that arm board pad cushions the patient's arm. Wrap the arm according to hospital protocol.
10. Place purple body strap across patient's arm and attach the body straps as follows:
 - A. Place the strap component with the small Velcro square around the table's accessory rail and through strap buckle.
 - B. Repeat the above step on the other side of the table with the remaining strap component with the Velcro's hook side facing downward. Join the straps together so that it goes over the patient's arm and chest
11. Place the patient's wrapped operative foot into stirrup, then tighten down according to hospital policy, and then begin postless hip distraction process.

Figure 1

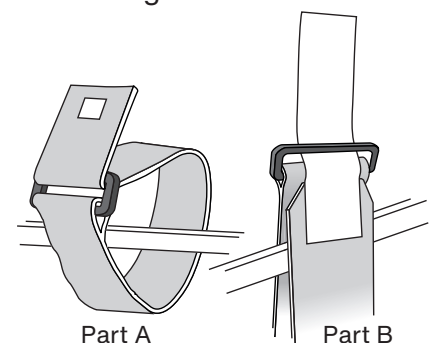
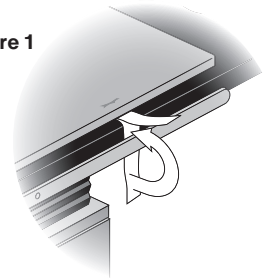

IMPORTANT:

- Position the patient's gluteal crease in alignment with the distal end of the pad.
- If the patient presents an anatomical challenge during attempted distraction, the use of Air Arthrogram could ease the distraction process.

ATTENTION:

- A. Before using The Pink Hip Kit, ensure O.R. table pad is securely affixed to the O.R. table.
- B. Be sure to follow your facility's policies and guidelines for frequency of patient monitoring. Check for skin integrity and proper circulation. Product is to be used by a licensed medical professional only.

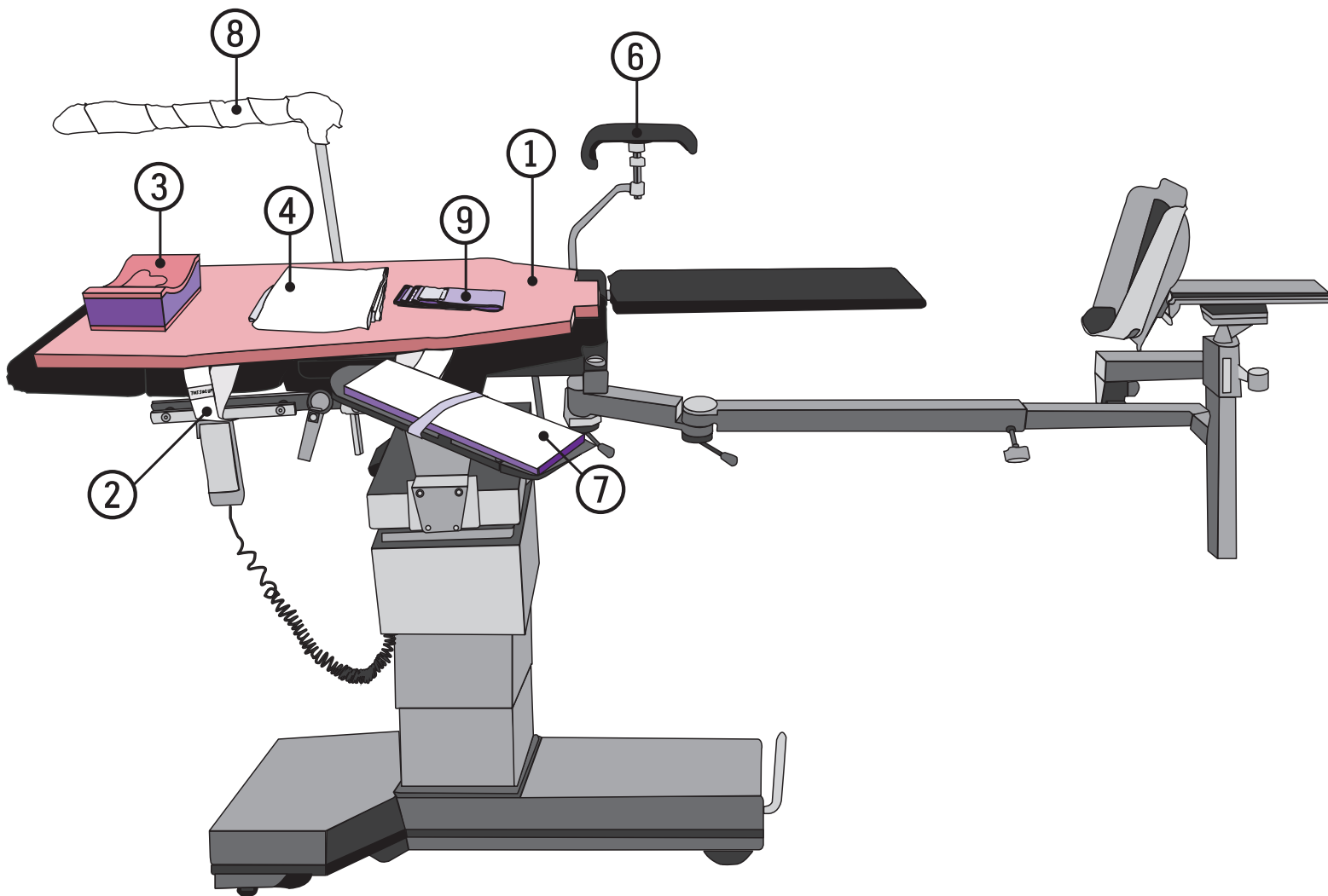

702 Prominence Drive
Pittsburgh, PA 15068 U.S.A.

Tel: 724.337.5500
Fax: 724.337.0555



xodusmedical.com
info@xodusmedical.com



FDA REGISTERED
ISO 13485 CERTIFIED

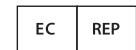

EMERGO EUROPE
Prinsessegracht 20
2514 AP The Hague
The Netherlands